

# 1470nm Series Diode Laser

## Product Description

1047nm series fiber coupled diode laser

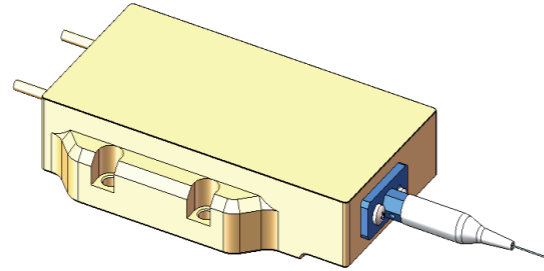

## Key Features

- Multiple single emitter based diode laser, high reliability
- With red light indicator light

## Applications

- Medical applications
- Material processing

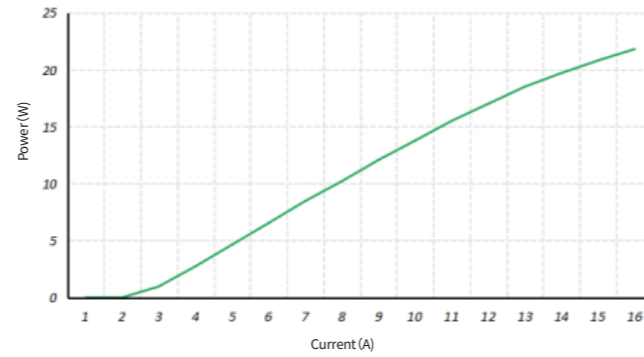

1470-10W Power curve

## Specifications

Parameter Unit	Unit	Parameter
Product Model		1470-10W
Output Power	W	10
Central Emission Wavelength	nm	1470±20

Parameter Unit	Unit	Parameter
Spectral Width (Fwhm)	nm	10
95% Power Within NA	NA	0.2
Conversion Efficiency	%	23
Threshold Current	A	1.2
Operating Current	A	9
Operating Voltage	V	6.4
Core Diameter	μm	400
Fiber Clad Diameter	μm	440
Operating Temp.	°C	15~40
Storage Temp.	°C	-20~85
Dimension	mm	67×48×18.47
Weight	g	≈80

· Customizable products allow flexible configuration of model parameters according to specific needs.